

HOUSE SERVICE CUTOUT - SERIES 108

FEATURES

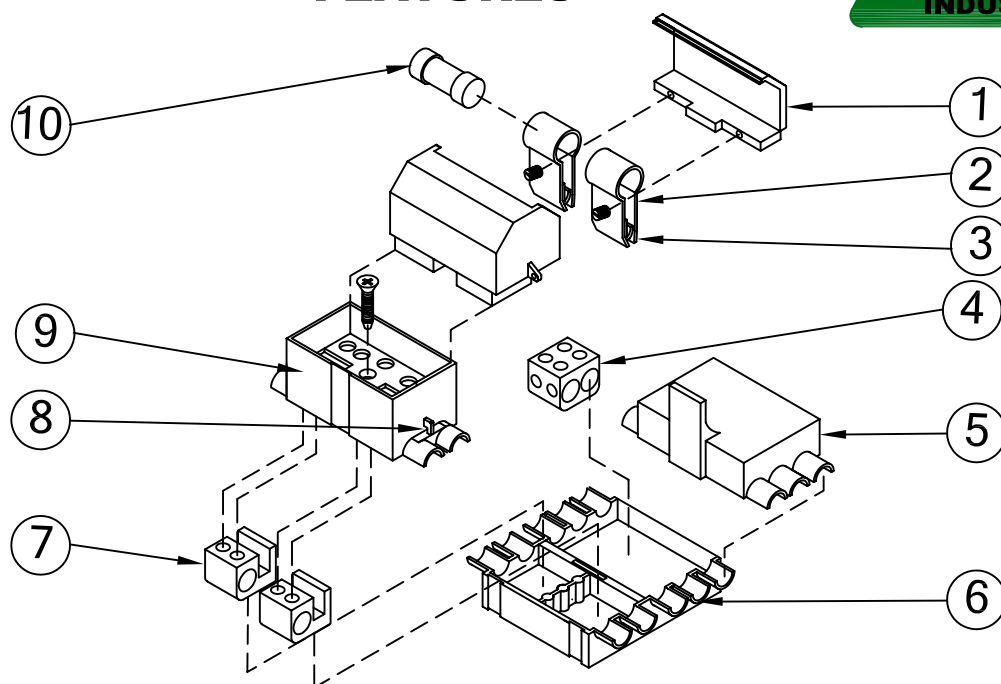

1. Fuse Carrier

Moulded from high quality mechanical, climatic , UV resistant glass reinforced polyamide and design for easy of operation.

2. Copper Fuse Clip

Copper Fuse Clip made from high grade copper, tinned, and perfectly fitting and self locating the fuse link. High pressure point contacts - wiping action ensures low resistance with tinned plated base contacts.

3. Pressure Pad

Phospho-bronze material Pressure plate to maintain the pressure with terminal slot for low resistance-everytime.

4. Neutral Terminal

Neutral Terminal made from high quality brass with pinching screw which will not damage the conductor strands for dependable operation.

5. Neutral Cover

Neutral cover is designed with interlocking moulding that only be removed until the fuse carrier is fully withdrawn.

6. Base

Moulded from high quality mechanical, climatic , UV resistant glass reinforced polyamide and design for each of operation. Its properties include good dielectric strength, flame retardent and high durability.

7. Incoming Terminal

Incoming and Outgoing terminal made from high quality Brass and tinned and suitable up to 35mm₂ conductor.

8. Sealing

Sealing wire facility to prevent unauthorized opening of the carrier and neutral cover.

9. Base Cover

Terminal Shroud to IP20 and design that carrier with be isolated before fully withdrawn and also protection from live terminal.

10. Fuse Link

Fuse Link to Type II a , BS: 1361:1991

DATA SHEET NO: HSC 15 R01

OMNIPRO INDUSTRIES SDN.BHD

PT 3316, Jalan Permata 1/1, Arab Malaysian Industrial Park, 71800 Nilai, Malaysia.

Tel: 606 - 799 5520 Fax: 606 - 799 5543 E-mail: oisb@omnipro.com.my Web: www.omnipro.com.my